

# NB-IoT and LTE Cat M1 Data Logger for Water Network



Smart Utility, Smart City

SKU: WSNBM-AQUA

## NB-IoT & LTE CAT M1 DATA LOGGER FOR WATER NETWORK WSNBM-AQUA



✓ Safe Zone

○ Hazardous Zones

The WSNBM-AQUA is a cutting-edge NB-IoT and LTE Cat M1 data logger tailored for comprehensive water pipeline network monitoring. It includes pulse inputs, an RS485 Modbus RTU Master Node, and built-in pressure sensors. Designed for long-term performance, the device operates efficiently on one or two batteries, offering a lifespan of 5 to 10 years. With support for global frequency bands, it is an ideal solution for city water networks, industrial parks, smart utility systems, and various other applications.

### Applications

Water Pressure Pipeline Monitoring

### Notes For Applications

- ✓ **Global Bands NB-IoT and LTE Cat M1**  
Easy connect to any NB-IoT and LTE Cat M1 Network over the World
- ✓ **10-Year battery**  
Ultra-low power sensing technology from Daviteq with Ultra-low power wireless technology allow the device can last up to 10 years
- ✓ **Multiple IO and Sensors**  
Pulse Input, Integrated Pressure Sensors, RS485 ModbusRTU Master Node
- ✓ **IP68**  
IP68 design for complete device

## NB-IoT & LTE CAT M1 DATA LOGGER FOR WATER NETWORK WSNBM-AQUA

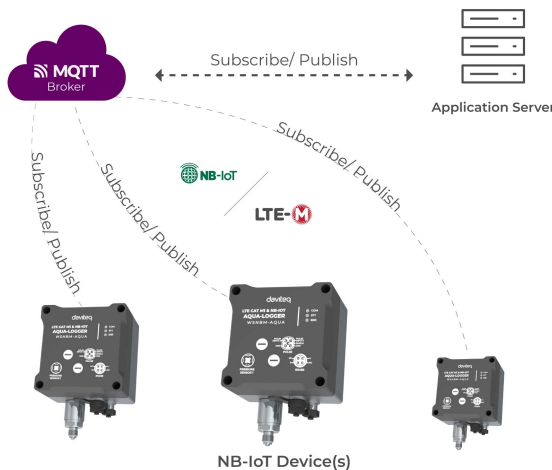

### SYSTEM ARCHITECTURE

#### DAVITEQ TECHNOLOGIES INC

Ho Chi Minh City, VN | Koblenz, DE | Melbourne, AU | Zurich, CH

+84.28.6268.2523 / 6268.2524

info@daviteq.com

www.iot.daviteq.com

Created date: Jul-16-2024

Updated date: Dec-16-2025

## Specification

|                       |  |
|-----------------------|--|
| Standard Inputs       | 02 x Pulses, 1 x RS485 ModbusRTU Master  |
| Optional Input        | 1 or 2 Pressure Sensors  |
| Digital Inputs        | 2-Digital channel inputs with dry-contact or voltage input (max 3.3VDC)  |
|                       | DI Functions: Logic Detecting or Pulse Counting  |
|                       | Logic Detecting: 2 channels, recommended minimum interval time between 02 statuses is 5 seconds.                     |
|                       | Pulse Counting: 2 channels, max frequency 100Hz, minimum Pulse width (low or high) is 200μS, counter is uint32 type. |
| RS485 Input port      | 1 x RS485 master port  |
|                       | Protocol: Modbus RTU   |
| Pressure Sensor       | Advanced Piezo technology  |
|                       | Measurement range: Select 0-10 barg, 0-16 barg, 0-20 barg  |
|                       | Over pressure protection: 1.5 x span   |
|                       | Accuracy & Stability: 0.25% or 0.5% of span, < 0.2% span/ year   |
|                       | Wetted parts: 304SS/316SS  |
|                       | Measuring Fluids: Any fluid which is workable with materials 304SS/316SS   |
|                       | Working temperature: -20~80°C  |
|                       | Compensation temperature: -10~50°C   |
|                       | Process connection: Standard G 1/4 or Others (consult factory)   |
| COMMUNICATION         |  |
| Connectivity          | LTE Cat NB1 for B1, B2, B3, B4, B5, B8, B9, B10, B12, B13, B17, B18, B19, B20, B25, B26, B27, B28, B66               |
| LTE Cat M1            | LTE HD-FDD B1/B2/B3/B4/B5/B8/B12/B13/B18/B19/B20/B25/B26/B27/B28/B66   |
| LTE Cat NB1/NB2       | LTE HD-FDD B1/B2/B3/B4/B5/B8/B12/B13/B17/B18/B19/B20/B25/B28/B66   |
| RF Power              | Class 3, 23 dBm ±2.7 dB  |
| Antenna               | Internal Antenna 2.0 dBi   |
| Battery               | 01 or 02 x D size 3.6VDC LiSOCl <sub>2</sub> Battery type, battery not included                                      |
| Working temperature   | -40~85°C (with SAFT LS33600 batteries)   |
| Dimensions/ Netweight | H170xW192xD97, 190g  |
| Housing               | Anodized Aluminum + Engineering plastic, IP68.   |

### DAVITEQ TECHNOLOGIES INC

 Ho Chi Minh City, VN | Koblenz, DE | Melbourne, AU | Zurich, CH

 +84.28.6268.2523 / 6268.2524

 info@daviteq.com

[www.iot.daviteq.com](http://www.iot.daviteq.com)

Created date: Jul-16-2024

Updated date: Dec-16-2025

## NB-IoT & LTE CAT M1 DATA LOGGER FOR WATER NETWORK WSNBM-AQUA



APPLICATION IN  
WATER NETWORK MANAGEMENT

## NB-IoT & LTE CAT M1 DATA LOGGER FOR WATER NETWORK WSNBM-AQUA

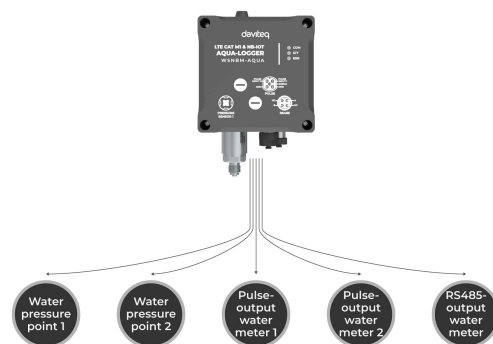

CONNECTIONS TO  
EXTERNAL DEVICE(S)

## NB-IoT & LTE CAT M1 DATA LOGGER FOR WATER NETWORK WSNBM-AQUA

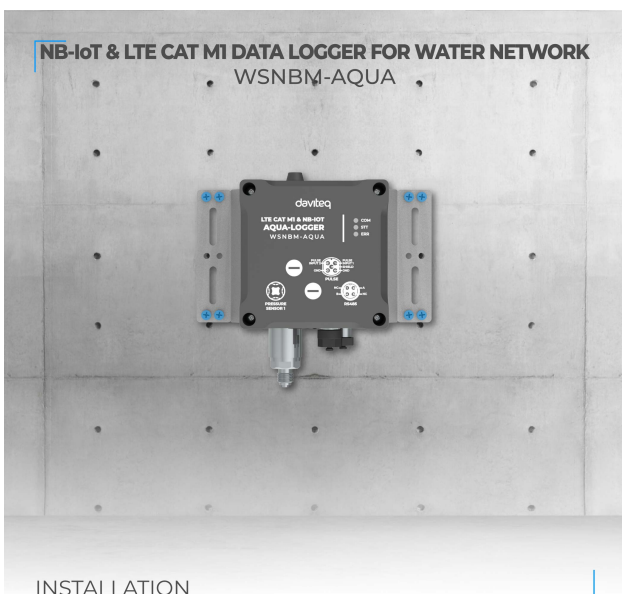

INSTALLATION

## NB-IoT & LTE CAT M1 DATA LOGGER FOR WATER NETWORK WSNBM-AQUA

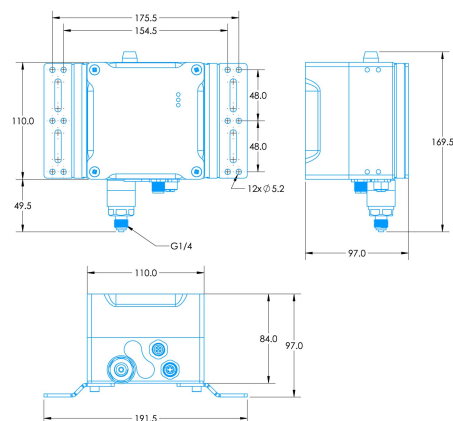

DIMENSION DRAWING OF  
WIRELESS NODE (Unit: mm)

## NB-IoT & LTE CAT M1 DATA LOGGER FOR WATER NETWORK WSNBM-AQUA



LS 33600  
Lithium battery

-60~85°C working temperature  
Low self-discharge rate  
17000 mAh capacity

RECOMMENDED BATTERIES

## NB-IoT & LTE CAT M1 DATA LOGGER FOR WATER NETWORK WSNBM-AQUA



PRODUCT PACKAGE

### DAVITEQ TECHNOLOGIES INC

Ho Chi Minh City, VN | Koblenz, DE | Melbourne, AU | Zurich, CH

+84.28.6268.2523 / 6268.2524

info@daviteq.com

www.iot.daviteq.com

Created date: Jul-16-2024

Updated date: Dec-16-2025

Ordering Information

| ITEM CODES         | DESCRIPTIONS   |
|--------------------|--|
| WSNBM-AQUA-1G10-IA | LTE Cat M1 and NBIoT Aqua-Logger Data Logger for Water Network, 2 x Pulse Inputs, 1 x RS485 ModbusRTU Master, 1 x Pressure Sensor 10 barg, Internal Antenna, IP68  |
| WSNBM-AQUA-2G10-IA | LTE Cat M1 and NBIoT Aqua-Logger Data Logger for Water Network, 2 x Pulse Inputs, 1 x RS485 ModbusRTU Master, 2 x Pressure Sensors 10 barg, Internal Antenna, IP68 |